

BAALE PRIVATE VILLAS & SPA, ARPORA, GOA
FULLY SERVICED RESORT HOMES



BAALE
WHERE THE
WORLD'S BEST
CONVERGE AT THE
DRAWING BOARD.



INTERIORS
G.A. DESIGN
LONDON, U.K.



LANDSCAPE
P. LANDSCAPE
BANGKOK, THAILAND



BAALE PRIVATE
VILLAS & SPA
ARPORA, GOA



ARCHITECT
POPO DANES
BALI, INDONESIA

TO OPEN DOORS TO THE FINEST VILLAS, WE FIRST OPENED THE FINEST MINDS.



POPO DANES

ART FOR LIFE'S SAKE: THE VISION OF POPO DANES ARCHITECT, BALI, INDONESIA

As Architects today, we not only design shelter and structure but develop design based on understanding living preferences. In that sense, we are lifestyle designers. We take into consideration the evolving, dynamic nature of modern lifestyles that are far from static. It is also critical for us to appreciate the universal need for a sense of place, space and living experience. Our projects are created and evolve from original, unique ingredients so that the experience they lend our clients – of a better, more colourful and vibrant life – is also unique. Based on these reflections, we are delighted to design Baale Private Villas & Spa at Arpora, Goa which allows us a fusion of design elements and a unique blend of architecture, lifestyle, and pleasure. More importantly, it brings together the best, collective design and living experience from all other influences around us – to the Goan experience we are now creating. We are very happy to deliver this design for Baale Private Villas & Spa at Arpora to let every soul celebrate their life in the most vivid and creative manner, inspired by the uplifting architectural philosophy of the property.



TERRY MCGINNITY

TAKING THE INDOORS OUTSIDE BRINGING THE OUTDOORS WITHIN INTERIORS, G.A. DESIGN, U.K

Baale Private Villas & Spa is situated in truly unique natural surroundings in Goa. G.A Design's intent is to harmonize the boundaries of the built interior with this natural exterior form. By taking reference from Balinese culture, the design of each residence will be accented with careful use of natural materials and sympathetic architectural design. Sourced from Bali, the natural Paras Jogja stone floors are inset with teak detailing. Entire walls will open up allowing the outside-in which gives inhabitants the optimum advantage of using the property's entire footprint. Natural stone floor will flow out from the internal areas, across the terraces and integrate into the landscape beyond, further bonding the living spaces together. This exclusive community of luxury villas at Baale Private Villas & Spa at Arpora is set to be the most unique and desirable in Goa.



PUI PHORNPRAPHA

THE TROPIC OF CONVERSATION LANDSCAPE, P. LANDSCAPE, THAILAND

Goa's tropical landscape will be recreated at Baale Private Villas & Spa to maintain synergy with the mainland. The boutique villa development will feature tropical landscape comprising of trees and plants that thrive in tropical climates. Balinese art and artefacts will further accentuate the thematic landscape. Each of the villas will have lily ponds, a swimming pool with Jacuzzi, gardens, sun or pool deck with swing sofas, feature walls etc. There is a common swimming pool and a common central park with trees and foliage lining the internal path leading to the villas.



KAPIL B. SINAI SURLAKAR

THROWING LIGHT ON ARCHITECTURE LIGHT@WORK, GOA

Light@Work is a design company that specializes in providing lighting solutions for architectural, urban and other related projects. We believe in leveraging the connection between light and architecture to enhance the overall environment of a space. Baale Private Villas & Spa, located in our hometown Goa is being developed by promoters, Architects and Designers, driven by a common vision to offer an international perspective and influence of tropical Balinese architecture. We aim to enhance the night time experience of these spaces with a sensitive and contextual response, in line with our collective vision.

Baale Private Villas & Spa is an organized, fully furnished and serviced boutique villa development. Eight bespoke villas sport cutting edge tropical design, world class construction quality and attention to detail, masterminded by the best designers worldwide. Each Villa is designed to be strictly compliant to Vaastu Shastra while also balancing the Chi factor, ensuring the wellness of our residents at all times.

The result is a stunning, exclusive, gated community resort that is well staffed with end-to-end maintenance for the privileged few. The resort lifestyle experience is further enhanced by unique Baale Club Services that takes care of well, everything.

The only
thing you
need to do
is enjoy it.





EXPLORING BALI IN BAALE

The origin of the name Baale is linked irrevocably to its tropical design heritage. Baale is a Balinese word referring to a gazebo that is covered from the top and open on four sides. This structure is representative of the tropical architecture of Bali. The Bali motif pervades the architecture of Baale Private Villas & Spa and at the hands of world renowned design talent, comes alive with contemporary yet authentic brilliance. Specially hand picked and imported sand stone, lime stone and volcanic rock from Bali has been used extensively in each villa and across the development, lending both luxury and Balinese sensibilities to the Baale landscape. Experience Bali, Indonesia in Baale, Goa.

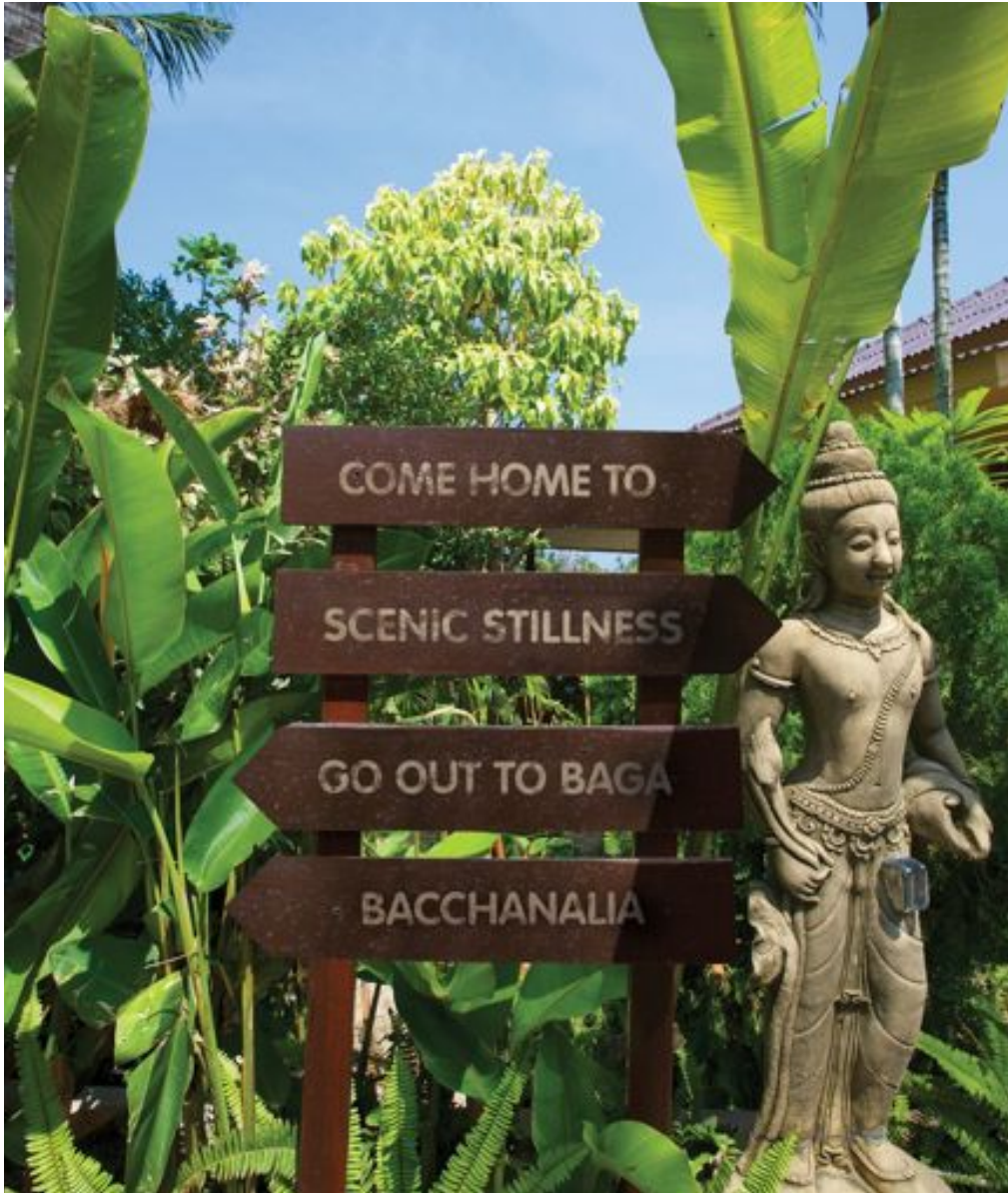

Baale Private Villas & Spa is situated in Arpora, a residential, quiet neighbourhood in the socially active and high profile area of North Goa. Arpora is nestled in natural green surroundings facing the Arpora Hill.

A highlight of the villa development is its enviable location in the middle of fields with an exclusive pathway leading up to it. And yet, the privacy of Baale Villas does not make it remote: instead, the property is an enticing 2 km away from Goa's beach and party hubs.

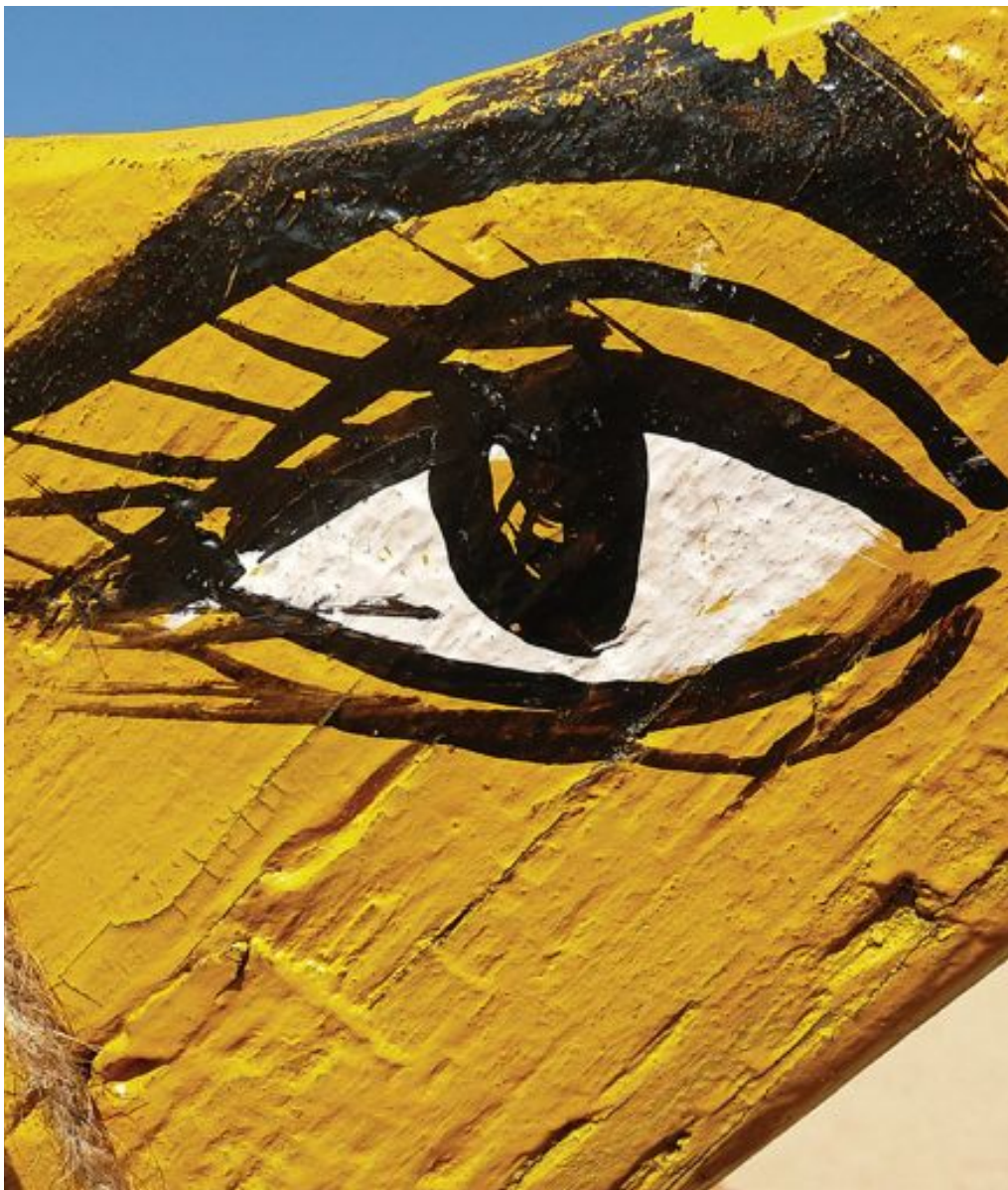

CLOSE TO
SERENITY
NOT FAR FROM
REVELRY
LIVING AND
LOVING IN
ARPORA

There will never be a dull moment when staying at Baale Private Villas & Spa, Arpora. That's because our splendid location brings a platter of delights to the table. Begin your day with freshly prepared breakfast at the Baale Club Cafe. Or order in-villa dining served by your personal butler in the comfort and luxury of your private villa. Or if you fancy a home cooked meal, then our concierge can organize a chef on call to prepare an exclusive meal of your choice in your villa. For other culinary conquests, our Concierge will be only too willing to organise delivery to your villa from any restaurant in Goa. Be it the local fish curry rice favourite, Subway, Dominos or even specialty seafood restaurants, the world is indeed your oyster.

And yet the party's far from over. Music comes to Arpora too, where local bands and artists on hire can tune in to make any celebration with friends or family truly special. For an unwind ritual, drift across to the Baale Club Spa or book in-villa spa services for some quiet soul searching at home.



LOCATION MAP

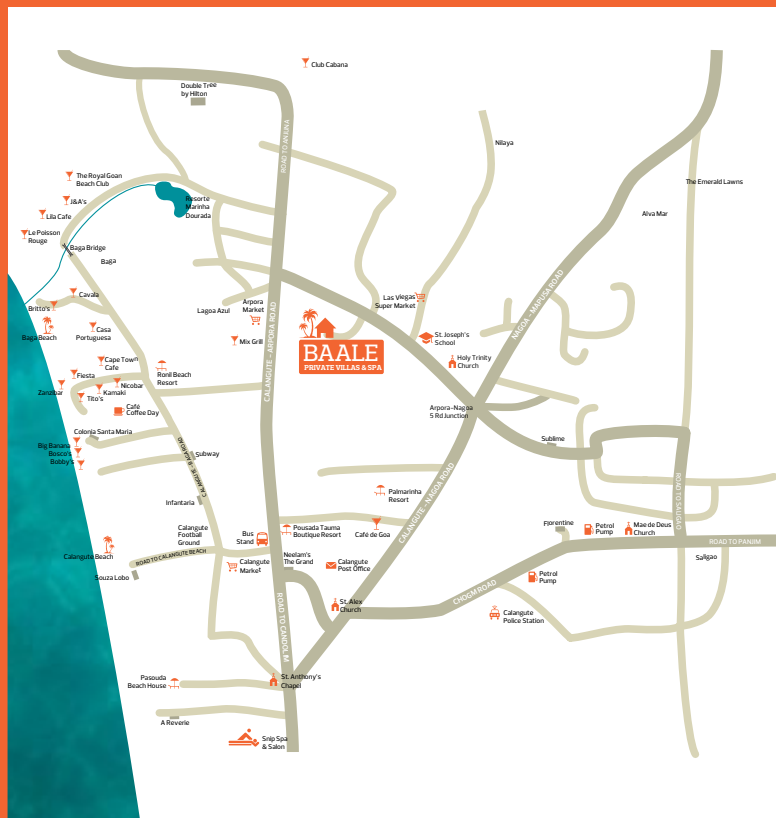

AIRPORT 47kms
 PANJIM 16kms
 CALANGUTE BEACH 3kms
 MORJIM 13kms
 ANJUNA 5kms
 VAGATOR 6kms
 FORT AGUADA 7kms

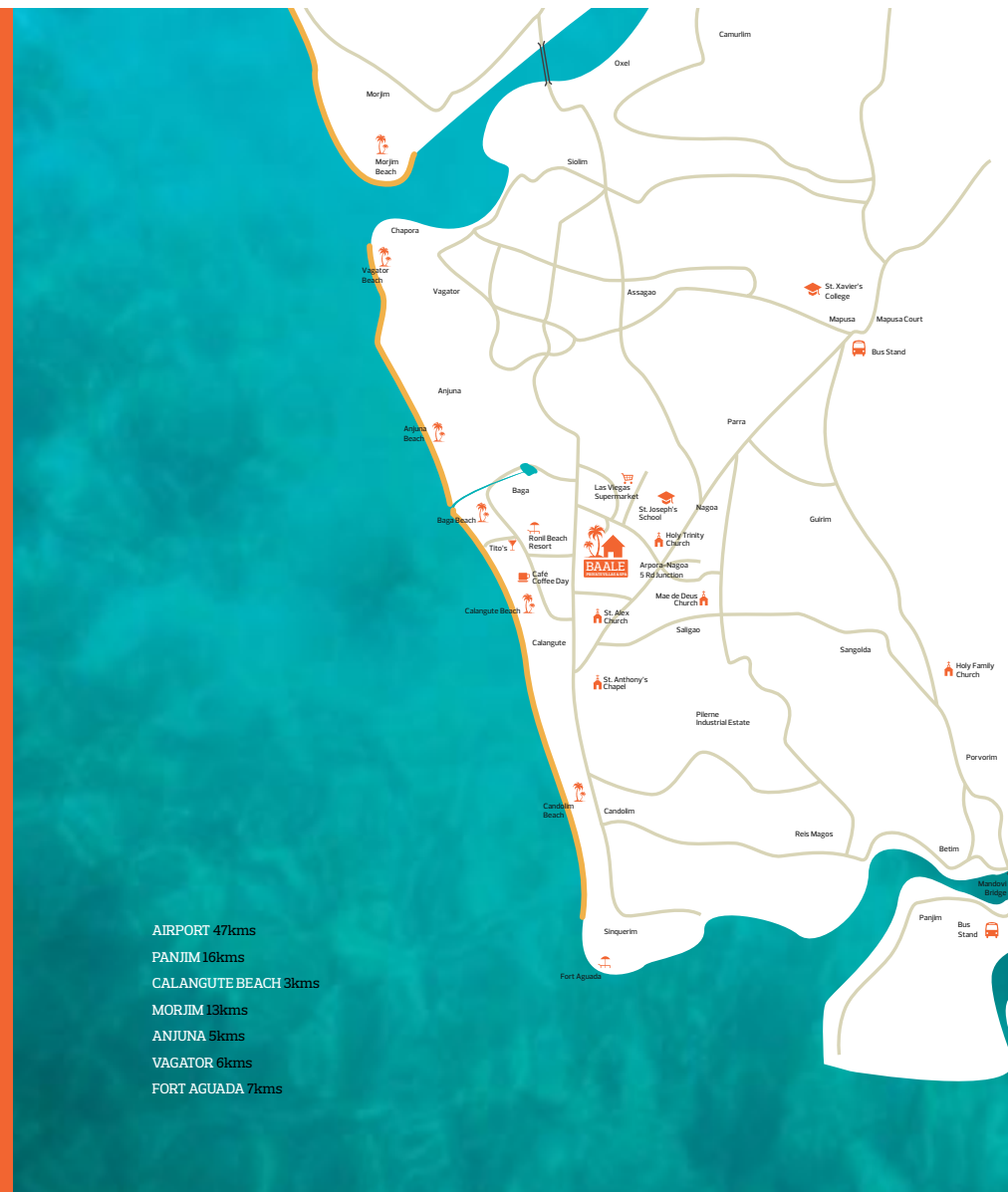

MASTER PLAN

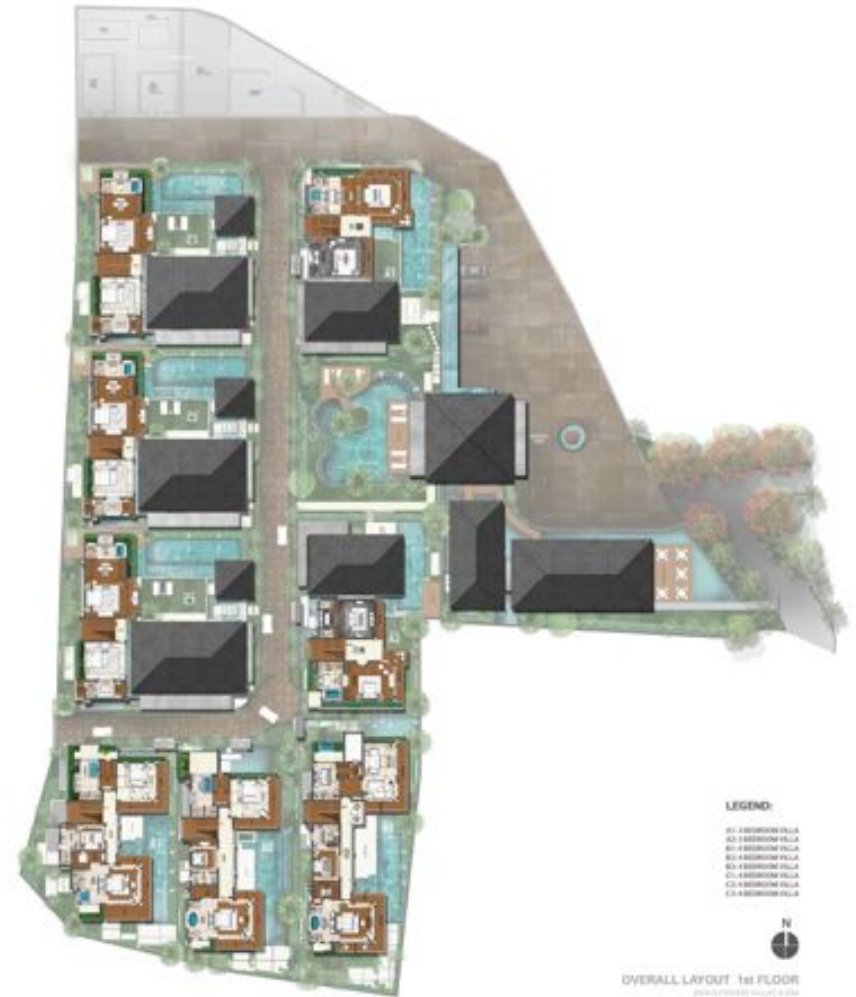

THE HOMECOMING





FULLY FURNISHED REASONS TO OCCUPY OUR EXQUISITE VILLAS.

Captivating Baale Private Villas & Spa are reminiscent of high-end properties in Bali. Live here and you'll be transported to an ambience that's both international and yet true to its tropical habitat.

Each villa has an individually designed signature landscape featuring garden spaces, lily ponds, sculptures, swing sofas and feature walls. Soak in the exquisite aspect of Balinese architecture and artifacts, spread your gaze over the seamlessness in interior and exterior landscape features and enjoy the thoughtful detailing in each room.

Marvel at the doors and full length windows that rise to 9 feet while gliding over the villa's specially designed flooring. And that's not all. Enjoy signature private swimming pools in each villa which are an impressive minimum 40 feet in length with an in built Jacuzzi and pool deck.

Now, all these elegant villas need is a like-minded owner. Come, feel the addiction.



Villa A

Coconut trees tower over fully fitted and furnished villas and their exposed wooden sloping roofs with Balinese rattan matting. While wrap around balconies framed in wood lean out to water bodies below.

VILLA A1
GROUND FLOOR PLAN



VILLA A1
UPPER FLOOR PLAN



PLOT AREA 466.20 Sq Mtrs | GROUND FLOOR SALEABLE AREA 299.41 Sq Mtrs | FIRST FLOOR SALEABLE AREA 118.99 Sq Mtrs | TOTAL SALEABLE AREA 418.4 Sq Mtrs

VILLA A2
GROUND FLOOR PLAN



VILLA A2
UPPER FLOOR PLAN





Villa B

Full length windows open out to private gardens where swing sofas and outdoor dining decks overlook seamless paddy fields. While high ceilings across the ground floor lend luxury to the interiors.

VILLA B1
GROUND FLOOR PLAN



VILLA B1
UPPER FLOOR PLAN



VILLA B2
GROUND FLOOR PLAN



VILLA B2
UPPER FLOOR PLAN



PLOT AREA 478.30 SqMtrs | GROUND FLOOR SALEABLE AREA 254.77 Sq Mtrs | FIRST FLOOR SALEABLE AREA 177.00 SqMtrs | TOTAL SALEABLE AREA 431.77 SqMtrs

VILLA B3
GROUND FLOOR PLAN



VILLA B3
UPPER FLOOR PLAN



PLOT AREA 468.77 Sq Mtrs | GROUND FLOOR SALEABLE AREA 243.86 Sq Mtrs | FIRST FLOOR SALEABLE AREA 179.89 Sq Mtrs | TOTAL SALEABLE AREA 423.75 Sq Mtrs

Villa C

Balinese villas reminiscent of a serene luxury spa present an inviting picture. Sloping wooden roofs, silent streams and gentle tropical foliage lull your senses.



VILLA C1
GROUND FLOOR PLAN



VILLA C1
UPPER FLOOR PLAN



PLOT AREA 605.23 Sq Mtrs | GROUND FLOOR SALEABLE AREA 375.97 Sq Mtrs | FIRST FLOOR SALEABLE AREA 123.87 Sq Mtrs | TOTAL SALEABLE AREA 499.84 Sq Mtrs

VILLA C2
GROUND FLOOR PLAN



VILLA C2
UPPER FLOOR PLAN



PLOT AREA 585.30 Sq Mtrs | GROUND FLOOR SALEABLE AREA 366.41 Sq Mtrs | FIRST FLOOR SALEABLE AREA 123.87 Sq Mtrs | TOTAL SALEABLE AREA 490.28 Sq Mtrs

VILLA C3
GROUND FLOOR PLAN



VILLA C3
UPPER FLOOR PLAN



PLOT AREA 555.25 Sq Mtrs | GROUND FLOOR SALEABLE AREA 348.31 Sq Mtrs | FIRST FLOOR SALEABLE AREA 123.87 Sq Mtrs | TOTAL SALEABLE AREA 472.18 Sq Mtrs



BEDROOM

Slip into luxury in our breathtaking master bedrooms (2 per villa) featuring spacious, well-crafted, tailor-made, his-and-her wardrobes. Savour its exquisite attributes: Beauty. Fine attention to detail and luxury in every inch. Truly, the stuff that dreams are made of.



BATHROOM

Baale Villas feature five fixture bathrooms with world class fittings; tailor-made spacious bath tubs; rain showers and outdoor shower courts. While sandstone-clad feature walls lend a tropical ambience to your bath experience.

LIVING ROOM

Our spectacular living rooms are well appointed with living and dining areas, a specially designed bar and all in all with aesthetic details to please the connoisseur in you.





WE'LL GO TO ANY LENGTHS
TO BRING YOU A SPECTACULAR
AQUATIC EXPERIENCE.

40 FEET AS A MATTER OF FACT.

Submerge yourself in the waters of your villa's luxurious outdoor heated swimming pool. Experience the sensation of the pool jacuzzi while connecting with your sublime surroundings.

WATER BRIDES

Lily ponds are an aquatic embellishment feature throughout our premises. Each villa has lily ponds in its landscape - an array of pink beauties bedecked on a tranquil blue-green watery bed.



A photograph of a wall with several vertical stripes of color: red, yellow, blue, and yellow. A blue banner with the word 'ART' in white capital letters is hanging on the blue stripe. To the right of the banner is a yellow shuttered door. The background to the right of the door is dark.

ART

ART IS
THE ONLY
WAY TO
RUN AWAY
WITHOUT
LEAVING
HOME.



FOR LIVING ROOMS
AND LIVING ROOM
CONVERSATIONS.

Balinese sculpture and art adorns the property





**OPEN SPACES
BREED OPEN MINDS.**

Landscape is an integral part of all provided amenities such as water features, intimate corners in lush greenery and satellite pavilions within garden areas. An aesthetic mingling of open spaces with tropical plant selection is a highlight of the Baale landscape.

HARVESTING THE GOOD LIFE

Baale Villa windows open out to a photogenic panorama of paddy fields. This view is framed for your privileged viewing by Baale Villa's full length windows and wrap around balconies.

PADDY FIELD VIEWS, ARPORA

THE INNER ROAD TO OUTER BEAUTY



CAFE TERRACE GARDEN



THE CENTRE OF CALM. THE CENTRE OF BEING.
THE CENTRAL POINT WE ALWAYS RETURN TO.

VILLA LANDSCAPE



CARRY A BOOK, A SONG IN YOUR HEAD,
OR A WISH TO CAST OUT IN THE SKY.

INNER COURTYARD OF VILLA C



WE THINK OF
EVERYTHING
SO YOU WORRY ABOUT
NOTHING



CLUBHOUSE
POOL
SPA
SALON
BAR
LIBRARY
PLAY AREA
GYM
CAFE

CONCIERGE
SERVICES
ASSET
MANAGEMENT
LEASE BACK
OPTIONS
A.A. WALKER
BEACH CLUB



CLUBHOUSE

The Club House cares for your mind and body with a suite of wellness services. A state of the art gymnasium takes your fitness a level up; our Spa and Salon opens doors to a zen like calm; the Pool table and common

swimming pool are points for buddies to converge while the Library cum business centre is perfect for some private study. And that's not all. A well serviced and stocked Cafe and Bar ensure you stay replenished during your time at the Club House.



Aroma Therapy

Manicure



BE WAITED ON HAND AND FOOT

Spa and Salon services at Baale Private Services & Spa, knead every worry out of your being, transporting you to a state of renewal and calm. From massage and reflexology to salon services like manicure, pedicure and haircare, our Spa is the destination for the world weary. In case you'd like some pampering in private, our services even come to your doorstep.





BAR WITH LIBRARY



CHILDREN'S PLAY AREA



FULLY EQUIPPED GYMNASIUM



POOL TABLE



WINE AND CIGAR LOUNGE



A. A. WALKER BEACH CLUB

The A. A. Walker Beach Club is an exclusive, recreational beach retreat, with complimentary access for owners and residents of Baale Private Villas & Spa. While being in the heart of seaside frolic, the Beach Club will be a protected space, offering guests the privacy that stems from privilege.

THE BAALE CONCIERGE SERVICES

The Baale Concierge Services are the exclusive prerogative of the owners and residents of Baale Private Villas & Spa. Awaiting you is an array of services to take your villa experience a notch above, to meet standards of world class luxury resorts.

Baale Concierge Services was conceived to address the security and maintenance concerns of potential buyers of Goan holiday homes. With our fleet of resort-like services now awaiting your arrival, Baale villas could be the investment you're seeking – emotional, spiritual and financial.

A wooden sign with the text "WE GIVE YOU NO ROOM FOR WORRY" is shown. The sign is resting on a reflective surface, creating a clear reflection of the sign and its text. The background is a blurred green, suggesting an outdoor setting with foliage.

WE GIVE YOU NO ROOM FOR WORRY

A FULLY
SERVICED
RESORT
LIVING
EXPERIENCE



AIRPORT DROP & PICKUP



CONCIERGE SERVICES



SAFETY & SECURITY



CHEF ON CALL



GROCERY SHOPPING
AND DELIVERY



PERSONAL ASSISTANT



IN ROOM SPA & SALOON



IN ROOM BOTANICALS



YOGA & MEDITATION
COURSES ON DEMAND



YACHT & CATAMARAN HIRE SERVICES



COMMON LAUNDRY SERVICES



EVENTS AND ENTERTAINMENT



IN ROOM DINING



HOUSE KEEPING



RESTAURANT & RESERVATIONS



BAAL CAR SERVICES



SAIL ON THE HIGH SEAS ANCHOR IN THE HIGH LIFE

Baale Yacht Services welcome you aboard. Exclusively yours for hire, the experience entices you to leave land far behind as you explore luxury in an all new terrain: the sea.

Come, feel the winds of change.



Pork Vindaloo
Kalamari Butter Garlic
Vegetarian Vindaloo
King Fish fillet fry
Mushroom and Cream Risotto
Pepper Steak
Spinach Ravioli
Chicken Sizzler
Baked potatoes with cream

ASSET MANAGEMENT
AS PER SCHEME CHOSEN
BY THE VILLA OWNER.

2

GOLD

This scheme includes all services offered by Silver plus House keeping and Internal Villa Cleaning including dish washing and Turn Down Service. Gold members can avail Concierge Services including airport pick-up and drop (at a nominal charge), stocking of the kitchen and bar, table booking at restaurants, organizing private parties at the premises, and movie viewing. All requests to be specified by the Villa Owner via email.

1

SILVER

This scheme includes the upkeep of only the common areas and external/outdoor Villa areas. Services include security, gardening, power backup, lighting (including basic external lighting as per energy efficient design to be lit on a daily basis to maintain the aesthetics of the development, irrespective of Villa being in use or not), villa garden, lily ponds and pool.

3

PLATINUM

This scheme includes Silver and Gold options plus all amenities and services offered by resorts and hotels namely Room Service, Flowers, Butler on call, Towels, Linen, Toiletries etc.



The next best thing to
living in your Baale Villa
is not living in it.





PROMOTING THE ESSENCE OF GOA

A. A. Walker is a developer of luxury residences in Goa and more importantly, a pioneer in the unique, all-new segment of asset-managed, fully furnished and maintained luxury villa homes. Baale Private Villas & Spa is an imminent Villa project, featuring a host of international architectural and landscape talent.

THE FINISHING LINE



BEDROOM CHAIRS



BEDROOM FURNITURE



PARTITION SCREENS



COFFEE TABLE

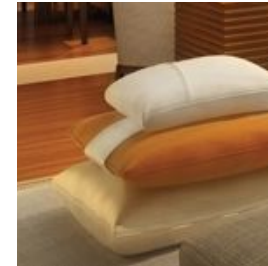

FURNISHINGS



BATHROOM WINDOWS



SLOPING RATTAN ROOF



BALINESE FURNITURE



GARDEN CHAIRS



DESIGNER FANS

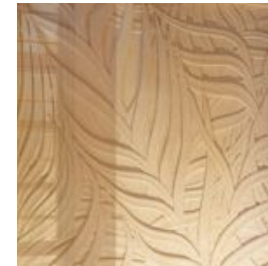

BALINESE ENGRAVING



WRAP AROUND BALCONIES



DAY BED



CUSTOMIZED LIGHTING



PATIO

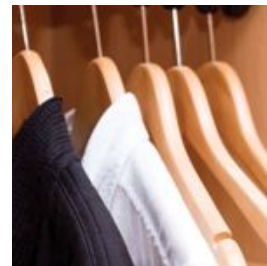

CUSTOMIZED WARDROBES

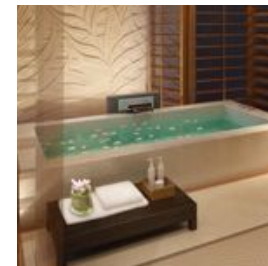

BATHROOM FIXTURES



ART & BOTANICALS

WHERE CONVENIENCE IS ALWAYS SWITCHED ON



TELEVISION



HOME THEATRE SYSTEMS



AIR CONDITIONERS



MODULAR KITCHEN AND CHIMNEY



BATHROOM FITTINGS



BATH TOWELS



FRIDGE, MICROWAVE & OVEN



KITCHEN APPLIANCES



COOKING UTENSILS



COMMON LAUNDRY



CAMERA INTERCOM



POWER BACKUP



KITCHEN INSTRUMENTS



CUTLERY



FOUR BURNER HOB



CCTV



SMOKE ALARM



HOME SAFETY & SECURITY

SPECIFICATIONS & CREDITS

AREA	WALLS	FLOOR	CEILING
SWIMMING POOL/ JACUZZI	Bissaza Glass Mosaics Tiles with Balinese Stone Coping.	Bissaza Glass Mosaics Tiles	
POOL DECK		Ipe Wooden Deck/ Grass Lawn	
LIVING ROOM/ DINING	POP punning with Vinyl Matt Emulsion	Engineered wood/ Spanish Stone	Slopping ceiling made of slatted timber and Rattan Matt/ Flat Ceiling made of POP/ Slatted Burma Teak Timber
MASTER BEDROOM 1	POP punning with Vinyl Matt Emulsion	Engineered Wood Flooring	Slopping ceiling made of slatted timber and Rattan Matt/ Flat Ceiling made of POP/ Slatted Burma Teak Timber
BEDROOM GROUND FLOOR (Configured as Media Room) Only in Villa B & C Type	POP punning with Vinyl Matt Emulsion	Engineered Wood Flooring	POP Ribbed Ceiling/ Vinyl Matt Emulsion in Vila C type: Flat Ceiling made of POP/ Slatted Burma Teak Timber/ Vinyl Matt Emulsion in Vila B type
MASTER BEDROOM 2	POP punning with Vinyl Matt Emulsion	Engineered Wood Flooring	Slopping ceiling made of slatted timber and Rattan Matt: Flat Ceiling made of POP/ Slatted Burma Teak Timber/ Vinyl Matt Emulsion
GUEST BEDROOM	POP punning with Vinyl Matt Emulsion	Engineered Wood Flooring	Slopping ceiling made of slatted timber and Rattan Matt
KITCHEN	POP Punning with Vinyl Matt Emulsion Paint	Vitrified Tiles/ Stone	POP false ceiling with Lacquer Paint
BATHROOM/ POWDER ROOM	Spanish Stone	Spanish Stone	POP Ceiling Vinyl Matt Emulsion Paint
UTILITY ROOM	POP Punning with Vinyl Matt Emulsion Paint	Vitrified tiles	POP Ceiling Vinyl Matt Emulsion Paint
MAIDS ROOM	POP Punning with Vinyl Matt Emulsion Paint	Vitrified tiles	POP Ceiling Vinyl Matt Emulsion Paint
MAIDS BATH	Vitrified tiles	Vitrified tiles	POP Ceiling Vinyl Matt Emulsion Paint
GAZEBO/ BAALE ONLY IN VILLA C TYPE		Ipe Wooden Deck	Slopping ceiling made of slatted timber and Rattan Matt

DOORS	WINDOWS / GLAZING	ELECTRONICS/ EQUIPMENT	FURNITURE
		Led Lights/ Filtration plant/ Heating Equipment	
		Bose Outdoor Speakers	2 sun loungers, coffee table
Solid Burma Teak/ Toughned Glass Glazing	Solid Burma Teak/ Toughend Glass Glazing	Telephone, Daikin Ductable Splits Ac units, Premium Modular Switches, LED TV, Bose AV System/ Speakers, DVD Player (Bose Home theatre only in Villa A Type)	5+2 seater sofa set, 10/8 seater dining table, Art and artifacts.
Internal Doors: Teak Veneered shutters. External Doors: Solid Burma Teak/ Toughned Glass Glazing	Solid Burma Teak/ Toughend Glass Glazing	LED TV, DVD player, Telephone, Daikin Ductable Splits Ac units, Premium Modular Switches	Four Poster Bed with Bed Side Tables, Day bed / sofa, 2 single seater sofas, Dressing table unit, Walk-in closet with four shutters wardrobe / Blinds, Art and artefacts, Bed linen with pillows, cushions etc
Internal Doors: Teak Veneered shutters. External Doors: Solid Burma Teak/ Toughned Glass Glazing	Solid Burma Teak/ Toughend Glass Glazing	LED TV, Bose Home theatre, DVD player, Telephone, Daikin Ductable Splits Ac units, Premium Modular Switches	3 seater sofa cum bed, 2 single seater sofa, media room console, Blinds, Art and artefacts, cushions etc
Internal Doors: Teak Veneered shutters. External Doors: Solid Burma Teak/ Toughned Glass Glazing	Solid Burma Teak/ Toughend Glass Glazing	LED TV, DVD player, Telephone, Daikin Ductable Splits Ac units, Premium Modular Switches	Double Bed with bedside units, Day bed / sofa, 1 single seater sofa with coffee table, Walk-in closet with four shutters wardrobe / Blinds, Art and artefacts, Bed linen with pillows, cushions etc. Balcony Furniture : One coffee table with 2 chairs.
Internal Doors: Teak Veneered shutters. External Doors: Solid Burma Teak/ Toughned Glass Glazing	Solid Burma Teak/ Toughend Glass Glazing	LED TV, DVD player, Telephone, Daikin Ductable Splits Ac units, Premium Modular Switches	Four Poster Bed with Bed Side Tables, Day bed / sofa, 3 single seater sofas, 3 shutters wardrobe / Blinds, Art and artefacts, Bed linen with pillows, cushions etc
Internal Doors: Teak Veneered shutters. External Doors: Solid Burma Teak/ Toughned Glass Glazing	Solid Burma Teak/ Toughend Glass Glazing	Siemens Make Hob, Chimney, Fridge, Oven, Microwave, IFB/ Kaif Make Dishwasher, Ice Cube Machine, Coffee Making Machine, RO Unit., Toaster, Glassware, Crockery, Cutlery and Utensils, Premium Modular Switches	Modular Kitchen, Engineered Stone counter top with Black Glass for splash back, Stainless steel sink, Imported CP fittings
Internal Doors: Teak Vennered Shutters	Solid Burma Teak/ Toughend Glass Glazing	All Sanitaryware & CP fittings by 'Bagno Design London', Built-in/ free standing bathtubs, Engineered Stone / Wooden Vanity Counter, Premium Modular Switches	Toilet accessories, Bathrobes, Slippers, Bath towel
Internal Doors: Teak Vennered Shutters	-	IFB Washing Machine & Dryer, Iron	
Internal Doors: Teak Vennered Shutters	Solid Burma Teak/ Toughend Glass Glazing		
Internal Doors: Teak Vennered Shutters	-	All Sanitaryware & CP fittings by 'Bagno Design London'	
			One table, 4 chairs

UTILITIES & SERVICES

100% Power Back up
Common Water Filtration/ Treatment Plant
Sewage Treatment Plant
WiFi Internet
Common Launderette
CCTV Security System

AMENITIES

Club Lounge Bar & Café
Spa & Salon
Gymnasium
Billiard/ Pool Table
Common Swimming Pool

VILLA MANAGEMENT & CONCIERGE SERVICES

Basic Services

24-hour Concierge Services
24-hour Front Desk/ Reception
24-hour Security
Airport Pickup & Drops
Maintenance of common area, exterior of villas, private pools and landscape

A La Carte Services

In-Residence Spa
In-Residence Dining
Yacht & Catamaran Reservation
In-Residence House Keeping
In-Residence Maintenance Services
Laundry Services
Car Hire Services
Restaurant Reservations
Yacht & Catamaran Reservation
Grocery Stocking & Delivery
Catering, Parties & Events

CREDITS

Principal Architect

Popo Danes, Bali, Indonesia

Landscape Design

P. Landscape, Thailand

Structural Design

Potential Semac, India

Interior Design

G.A. Design International, UK

Lighting Design

Light@Work, India

Project Advisor

Quadriga Design, India

NOTE: All specifications and facilities are tentative, which may vary as decided by the Developer/ project architect, whose decision shall be final and binding. Wherever brands are mentioned, the Developer may use equivalent brands at their own discretion.

